

Developer Series | 4 Bedroom | Open Plan Living | 1 Bathroom | Separate Laundry

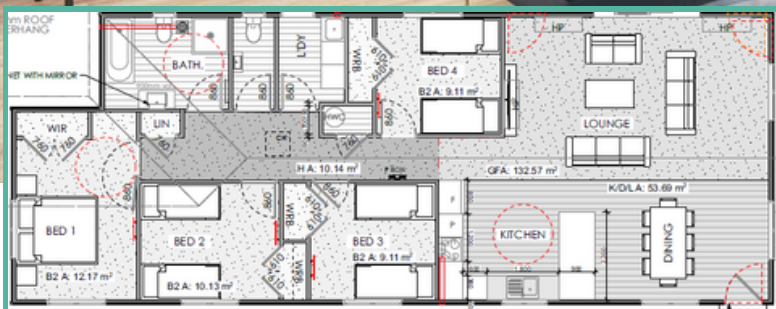

Example interior only.
Plans can be flipped and mirrored.



Length 19m | Width 7.3m | Area 133m²



1



4



1



2

Spacious Four-Bedroom **Perfect for Buyers**

The Ideal Home for Today's Market - This property combines comfort and versatility, boasting a flexible design perfect for expanding families or shared living arrangements. It offers a contemporary open-plan layout with a seamless indoor-outdoor flow. New Zealand property developers can experience convenience and efficiency by partnering with Transbuild Commercial. Opting for offsite manufacturing helps save both time and money.

Specification Options

- ✓ Single or Double Story dwellings
- ✓ Stand alone, Duplex, or Terrace
- ✓ N, S, E, W Entry
- ✓ Mirrored or Flipped Plans
- ✓ Accessibility & FUD
- ✓ M255 compliant design
- ✓ Homestar rated housing
- ✓ Pile or slab foundation options
- ✓ Transbuild Entry Level Plans
- ✓ Investor Spec, Owner Occupier, or Custom Spec

Benefits

- ✓ Use our plans or yours
- ✓ Simple, Fast, Delivered
- ✓ Fixed price: no hidden costs
- ✓ Low cost
- ✓ High quality homes
- ✓ Architecturally designed
- ✓ 8 - 10 week build time