

Developer Series | 2 Bedroom | Open Plan Living | 1 Bathroom

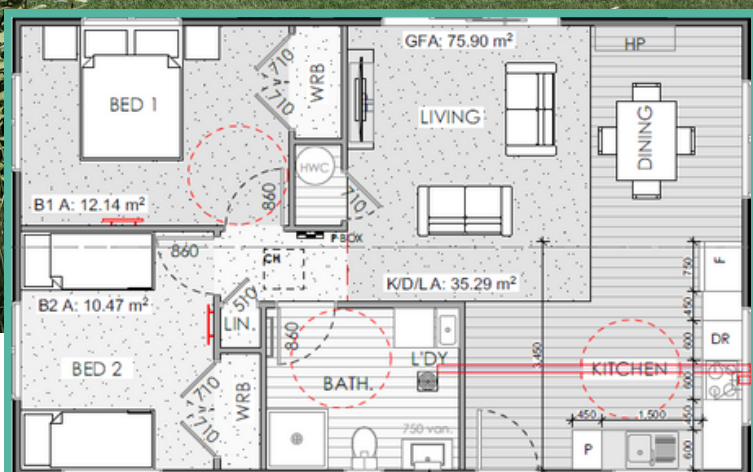

Artist impression only. Decking not included.
Plans can be flipped and mirrored.



Length 11m | Width 6.9m | Area 76m²



1



2



1



1

Compact & Efficient Living with Seamless Flow

A cleverly designed two-bedroom transportable home that maximises space and functionality. The open-plan layout integrates kitchen, dining, and living areas, creating a practical, efficient solution for residential property development. With an emphasis on natural light and architectural design this ready-made home solution ensures a cost-effective build with modern appeal.

Specification Options

- ✓ Single or Double Story dwellings
- ✓ Stand alone, Duplex, or Terrace
- ✓ N, S, E, W Entry
- ✓ Mirrored or Flipped Plans
- ✓ Accessibility & FUD
- ✓ M255 compliant design
- ✓ Homestar rated housing
- ✓ Pile or slab foundation options
- ✓ Transbuild Entry Level Plans
- ✓ Investor Spec, Owner Occupier, or Custom Spec

Benefits

- ✓ Use our plans or yours
- ✓ Simple, Fast, Delivered
- ✓ Fixed price: no hidden costs
- ✓ Low cost
- ✓ High quality homes
- ✓ Architecturally designed
- ✓ 8 - 10 week build time