

Developer Series | 2 Bedroom | Open Plan Living | 1 Bathroom

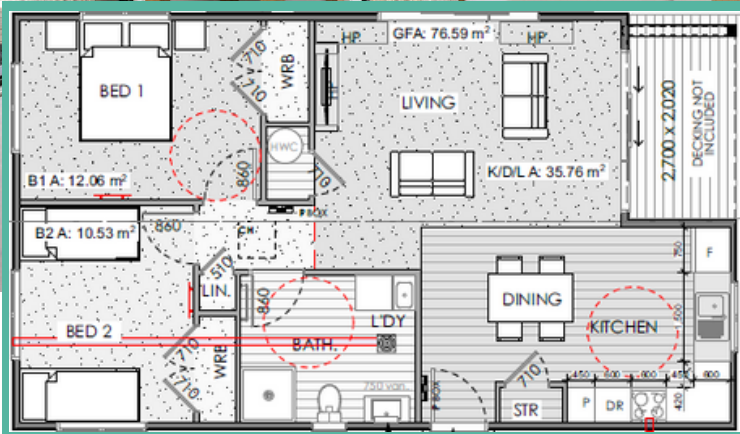

Example interior only.
Plans can be flipped and mirrored.



Length 12m | Width 6.9m | Area 76m²



Attract Buyers with Open-plan Living Extending Outdoors

This cleverly configured home offers a functional two-bedroom layout with a focus on open living. Dual ranch sliders enhance the indoor-outdoor connection, providing an attractive feature for property developers looking for practical, ready-made houses NZ solutions that Kiwis will love.

Specification Options

- ✓ Single or Double Story dwellings
- ✓ Stand alone, Duplex, or Terrace
- ✓ N, S, E, W Entry
- ✓ Mirrored or Flipped Plans
- ✓ Accessibility & FUD
- ✓ M255 compliant design
- ✓ Homestar rated housing
- ✓ Pile or slab foundation options
- ✓ Transbuild Entry Level Plans
- ✓ Investor Spec, Owner Occupier, or Custom Spec

Benefits

- ✓ Use our plans or yours
- ✓ Simple, Fast, Delivered
- ✓ Fixed price: no hidden costs
- ✓ Low cost
- ✓ High quality homes
- ✓ Architecturally designed
- ✓ 8 - 10 week build time